

NGG - 10 BATHROOM.

Master 16/5-2011

LOTORNEJEN

Problem area

NGG 10

PEDESTRIAN

NO TRAFFIC

SCHOOL PARKING ZONE

PEDESTRIANS DROP-OFF

STAFF/PARKING

KVIK + WASK

CHRISTIANSBUS

STAFF PARKING

CIRKELHUSET

CHRISTIANSBUSVEJ

School patrol

JYSK

HEATHER'S PROPOSAL FOR PARKING FLOW ②

NGG 10 PARKING PLAN

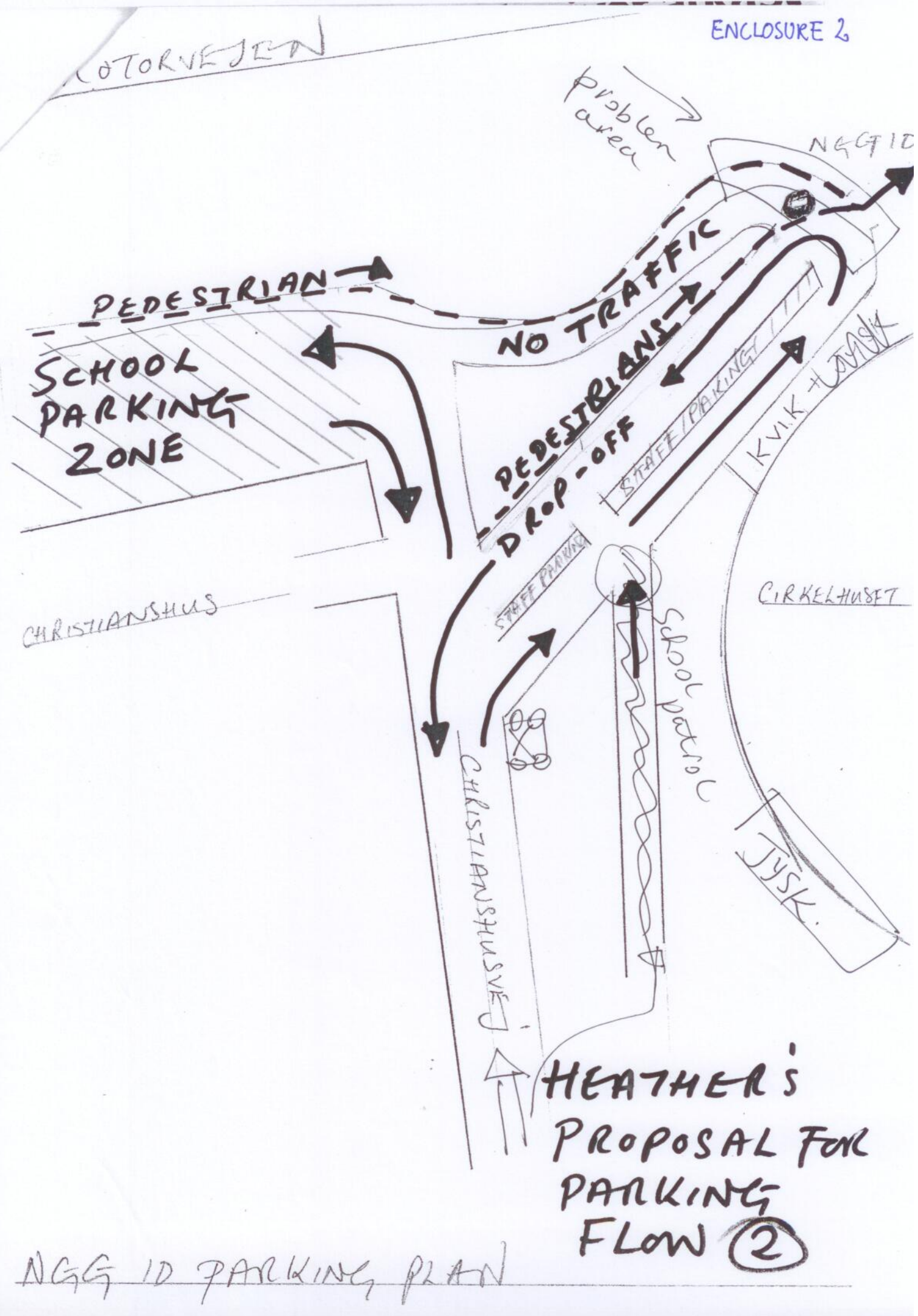

AULA RE-VAMP 16/5-2011

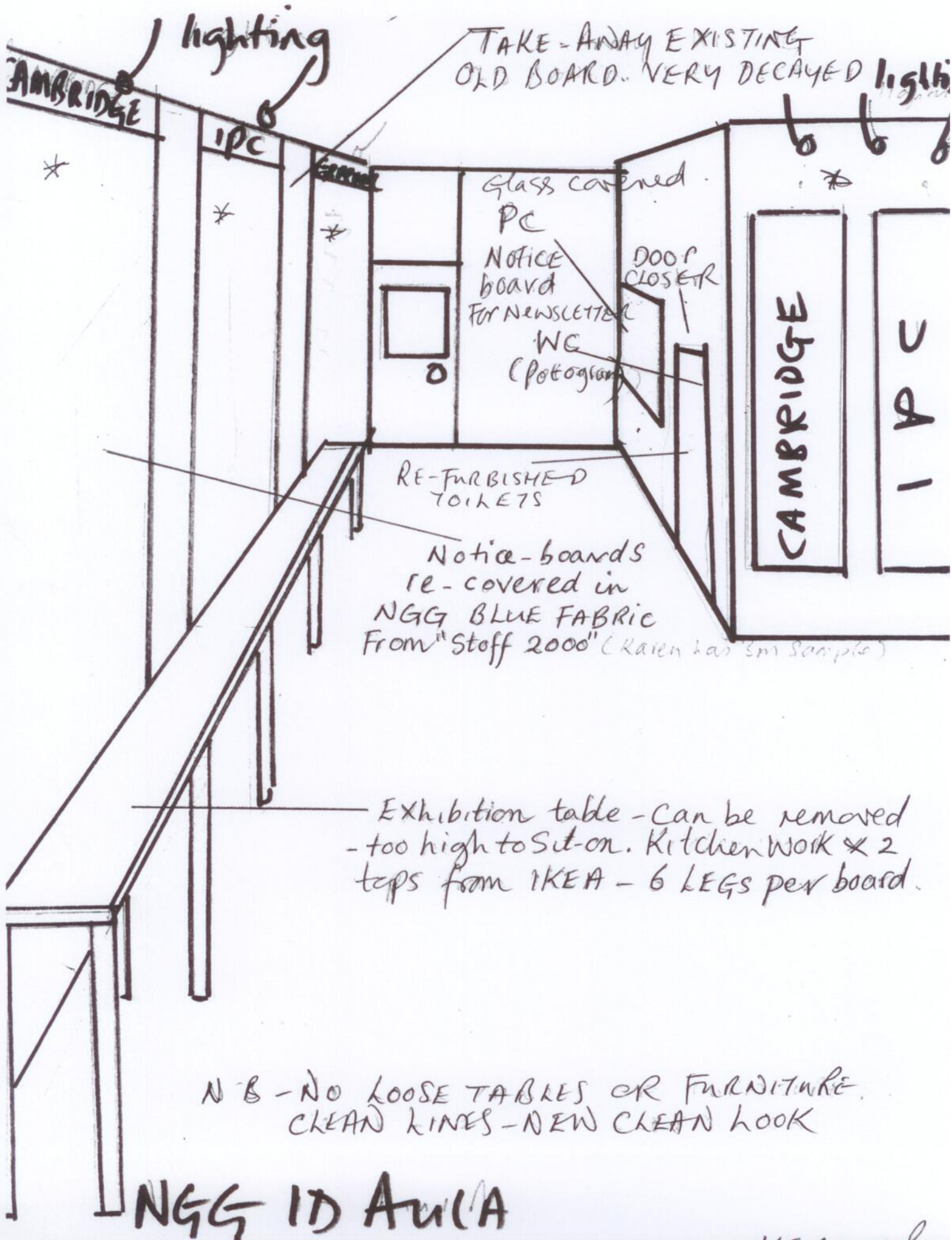

NGG ID AULA PROJECT.

Heather 16/5-2011

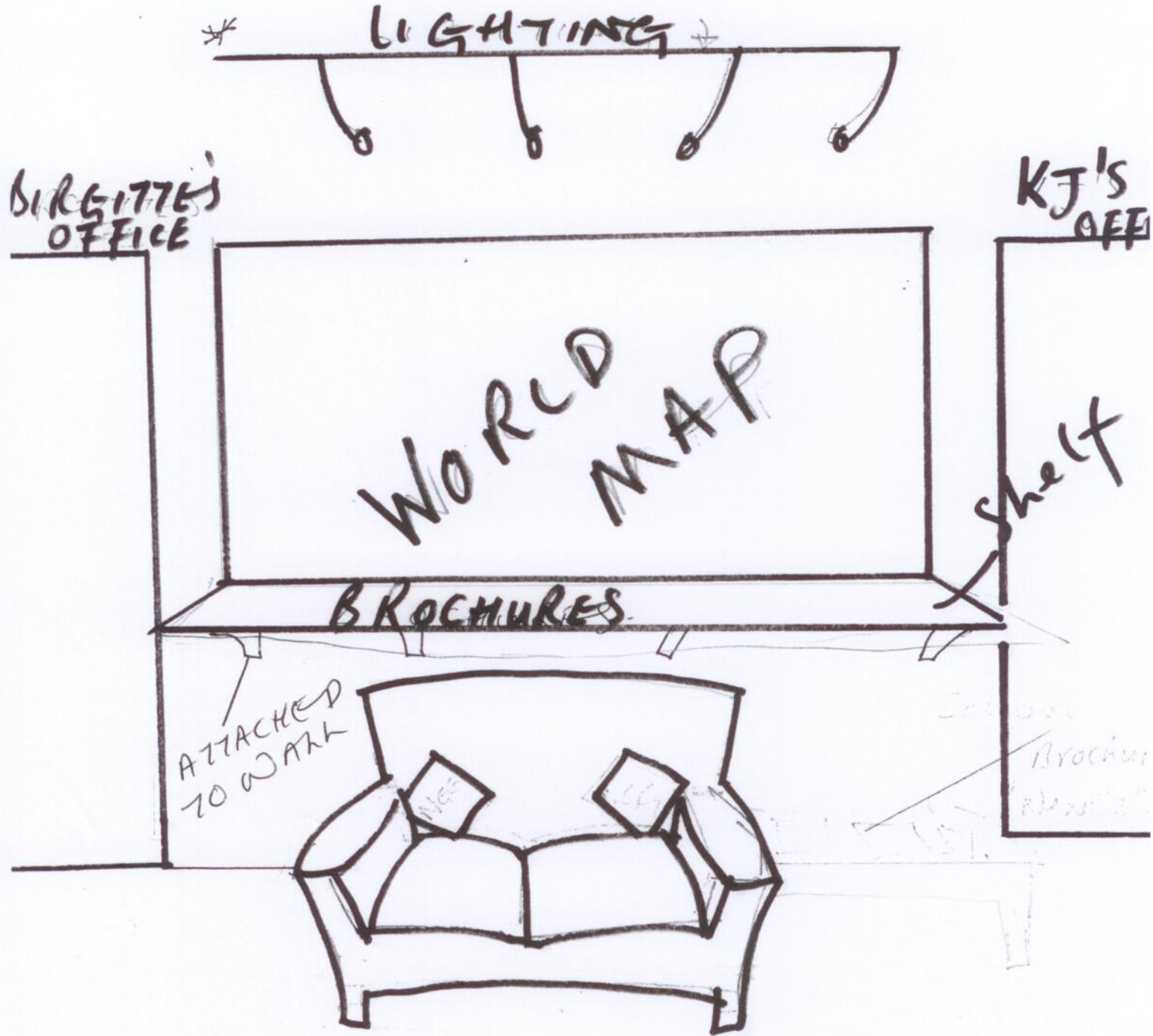

NB - TAKE AWAY PC NOTICEBOARD - RE
LOCATE NEAR BATHROOM.

HEATHER